

Connection diagram:

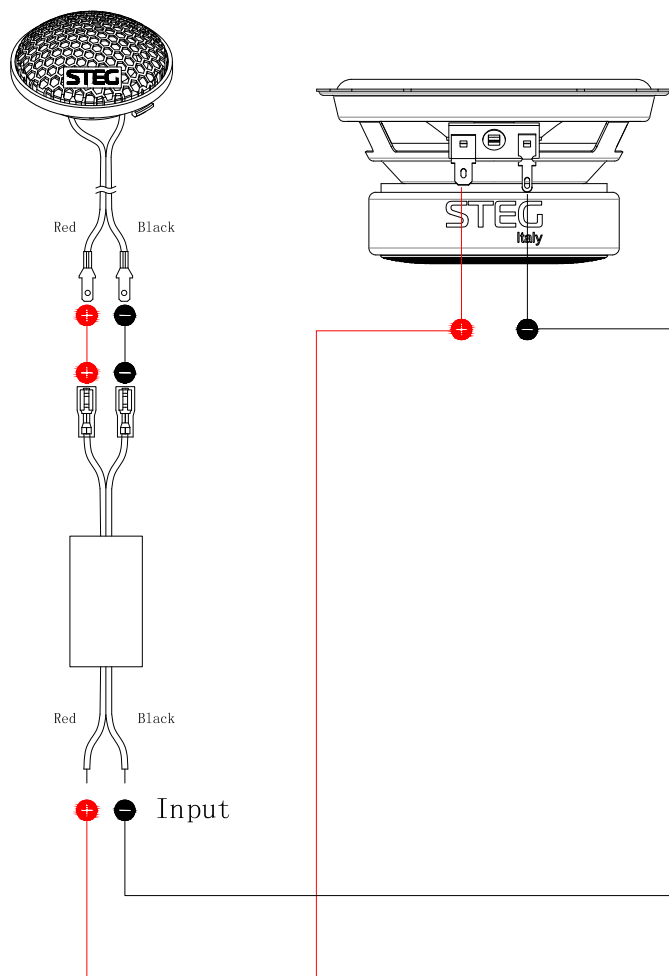

SQ

COMPONENT SPEAKERS

SQ 100C

Installation Instructions



ITALY
www.gt-trading.it
info@gtrading.it

Surface mounting option

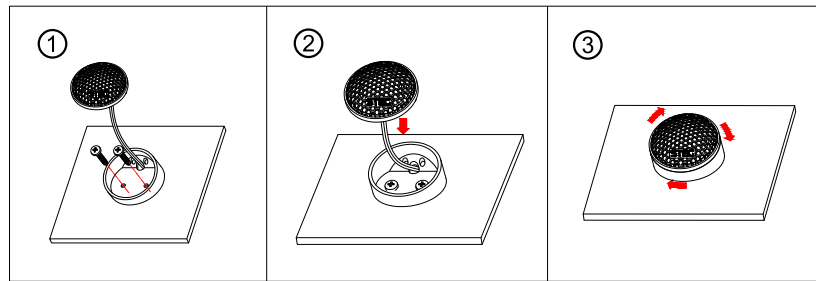

Flush mounting for 50mm cutout

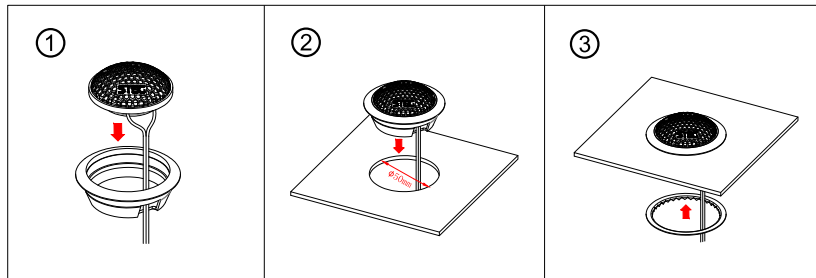

Specifications		
2-Way System		SQ100C
Nominal Impedance		4 ohm
Power Handling		40W
Max.Transient Handling		80W
Sensitivity(2.83V/1M)		88dB
Frequency Response		75-20K Hz
Voice Coil Diameter	Woofers	25mm(1")
	Tweeter	25mm(1")
Voice Coil Wire		Copper
Magnet System	Woofers	High grade ferrite magnet
	Tweeter	Neodymium
Mounting Depth		53mm

Tweeter list

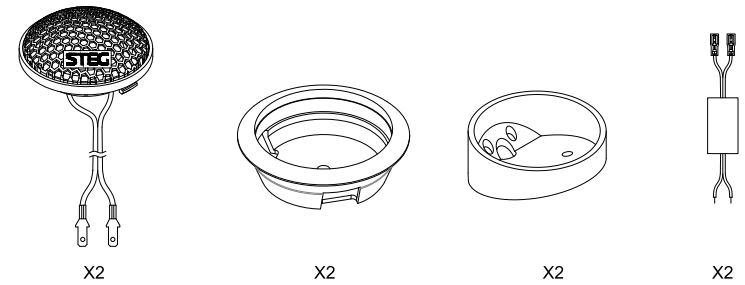

Woofer list

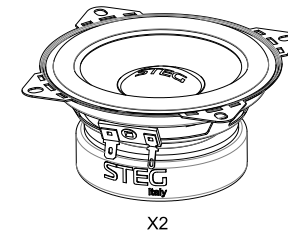

Woofer mounting

